

BOLT LIST FOR ASSEMBLY RA/V1				
Diam	Grade	Length	No.	No. Required
22		60	4	8
(Total bolt one assembly X no of assembly)			Total	32

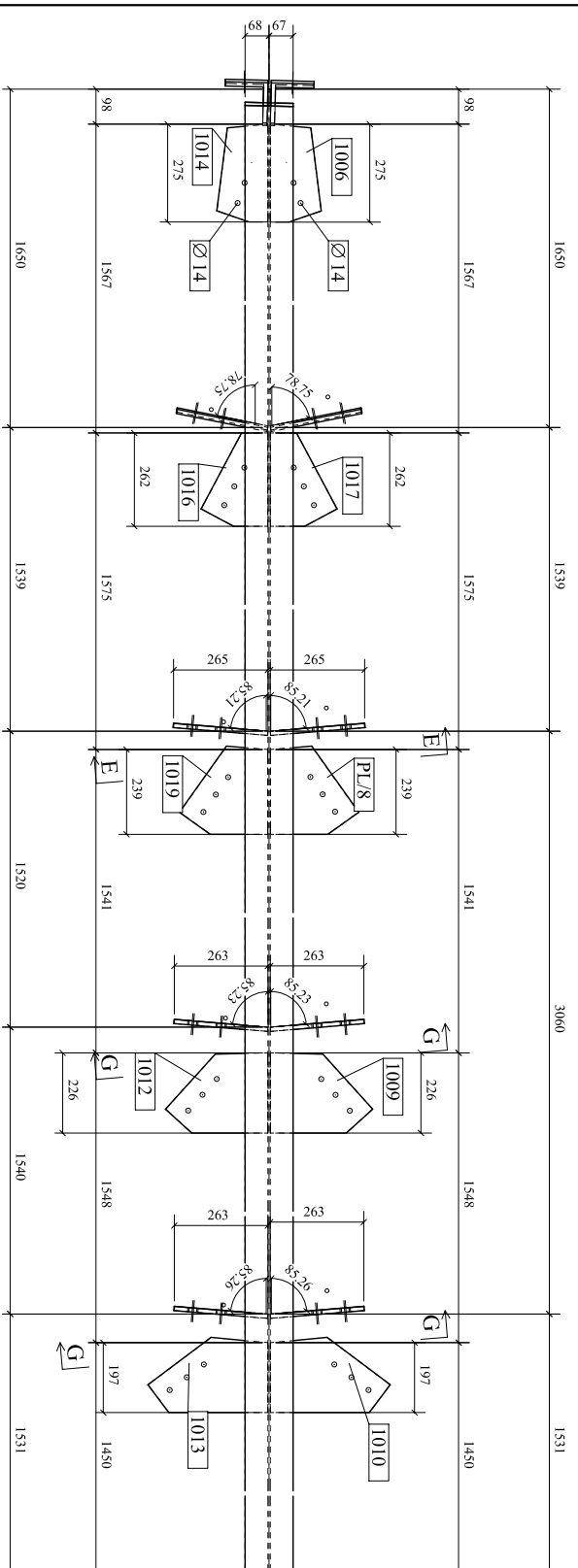

E - E

D - D

F - F

H - H

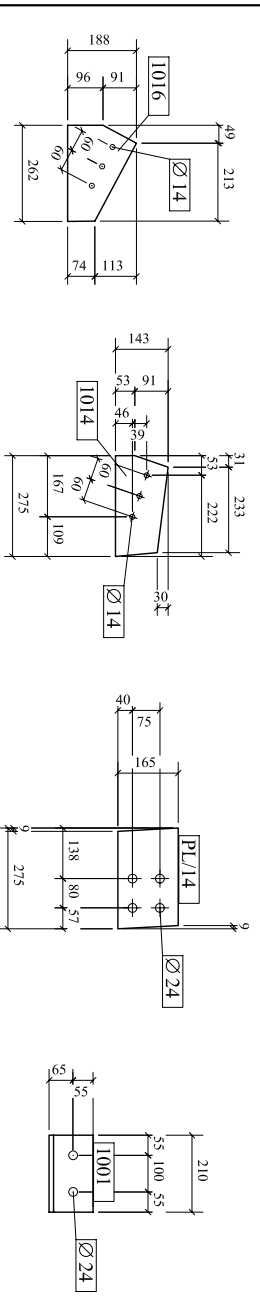
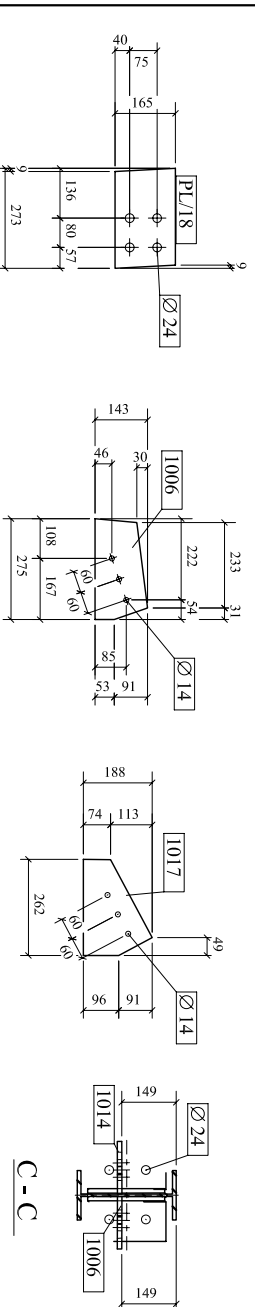
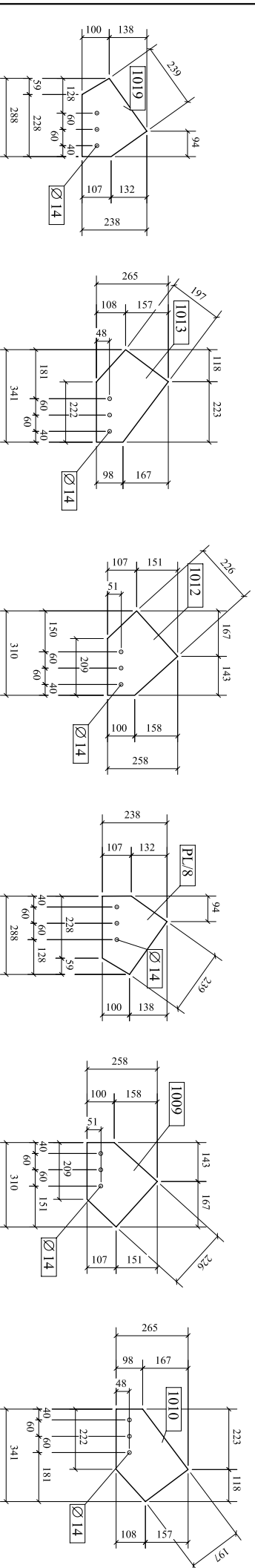

MATERIAL LIST FOR ONE ASSEMBLY MARKED							
Mark	Size	No.	Length	Area	Weight	Total Area	No. Required
4	IPe270	1	7781	8.100	280.34	8.100	280.34
1001	L120*12	1	210	0.098	4.533	0.098	4.533
1002	L120*12	1	210	0.098	4.533	0.098	4.533
1006	PL12*143	1	275	0.076	3.138	0.076	3.138
1009	PL12*238	1	311	0.111	4.735	0.111	4.735
1010	PL12*265	1	341	0.122	5.218	0.122	5.218
1012	PL12*238	1	311	0.111	4.735	0.111	4.735
1013	PL12*265	1	341	0.122	5.218	0.122	5.218
1014	PL12*143	1	275	0.076	3.138	0.076	3.138
1016	PL12*188	1	262	0.078	3.253	0.078	3.253
1017	PL12*188	1	262	0.078	3.253	0.078	3.253
1019	PL12*238	1	288	0.102	4.303	0.102	4.303
1025	PL12*165	1	270	0.096	4.047	0.096	4.047
PL/8	PL12*238	1	288	0.102	4.303	0.102	4.303
PL/11	PL12*165	1	270	0.096	4.047	0.096	4.047
PL/14	PL12*165	2	275	0.098	4.140	0.197	8.281
PL/18	PL12*165	4	273	0.098	4.108	0.390	16.433
(Total in one assembly)					Sub Total	100.056	363.51
(Total one assembly X no of assembly)					Total	80.448	2908.1

FOR SAMPLE

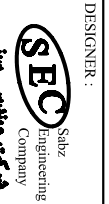

DESIGNER: SIRRI GAS COMPRESSION FACILITIES, EPC-3
 OFF-SPEC CONDENSATE STORAGE TANK
 2500M³ CONE ROOF-TK-143-T-102
 RAFTER DETAIL